



NICHOLS LONG & MOORE CONSTRUCTION CORP.

770 Riverview Boulevard
Tonawanda, NY 14150
(716) 759-2842 Fax (716) 332-0467

January 18, 2018

Reference: NYSDOT Project No. D263522
Bridge Replacement of Bethany Center Road
Over Route 20 in the Town of Bethany

Subject: Notice of Scheduled Highway Detour for Bridge Replacement

Nichols, Long & Moore Construction has been contracted by New York State Department of Highways to replace a Genesee County Bridge for Bethany Center Road (C.R. 15) over US 20 located in Bethany, New York.

The work is scheduled to begin on April 8th and will require a temporary detour of Bethany Center Road to avoid crossing over US 20 to adjacent roadways and will remain in place until the new Bridge is completed on September 1, 2018. Enclosed is a map of Detour "A" to use during the construction.

Also during the construction of the new bridge there will be three separate Detours of US 20 around the construction of the new Bridge to avoid traffic under the demolition and bridge erection stages of the work. These detours will reroute traffic on a local nearby road for all traffic for US 20 per the attached map Detour "B" for the following estimated dates.

- Bridge Demolition: April 9th to April 22nd beginning at 7:00 AM and ending at 7:00 AM.
- Bridge Erection: June 5th to June 8th beginning at 7:00 AM and ending at 7:00AM
- Concrete Placement: July 10th to July 12th beginning at 5:00 AM and ending at 5:00 AM

You may contact myself or the NYSDOT Engineer Todd Clark at (585) 797-9225 for more information regarding updates of the Detours.

Sincerely,

Randy S. Callahan

Nichols, Long Moore Construction
Randy S. Callahan
Senior Project Manager

cc: Todd Clark, NYSDOT EIC

WORK ZONE TRAFFIC CONTROL
BETHANY CENTER ROAD SOUTH BOUND DETOUR

DETOUR "A"

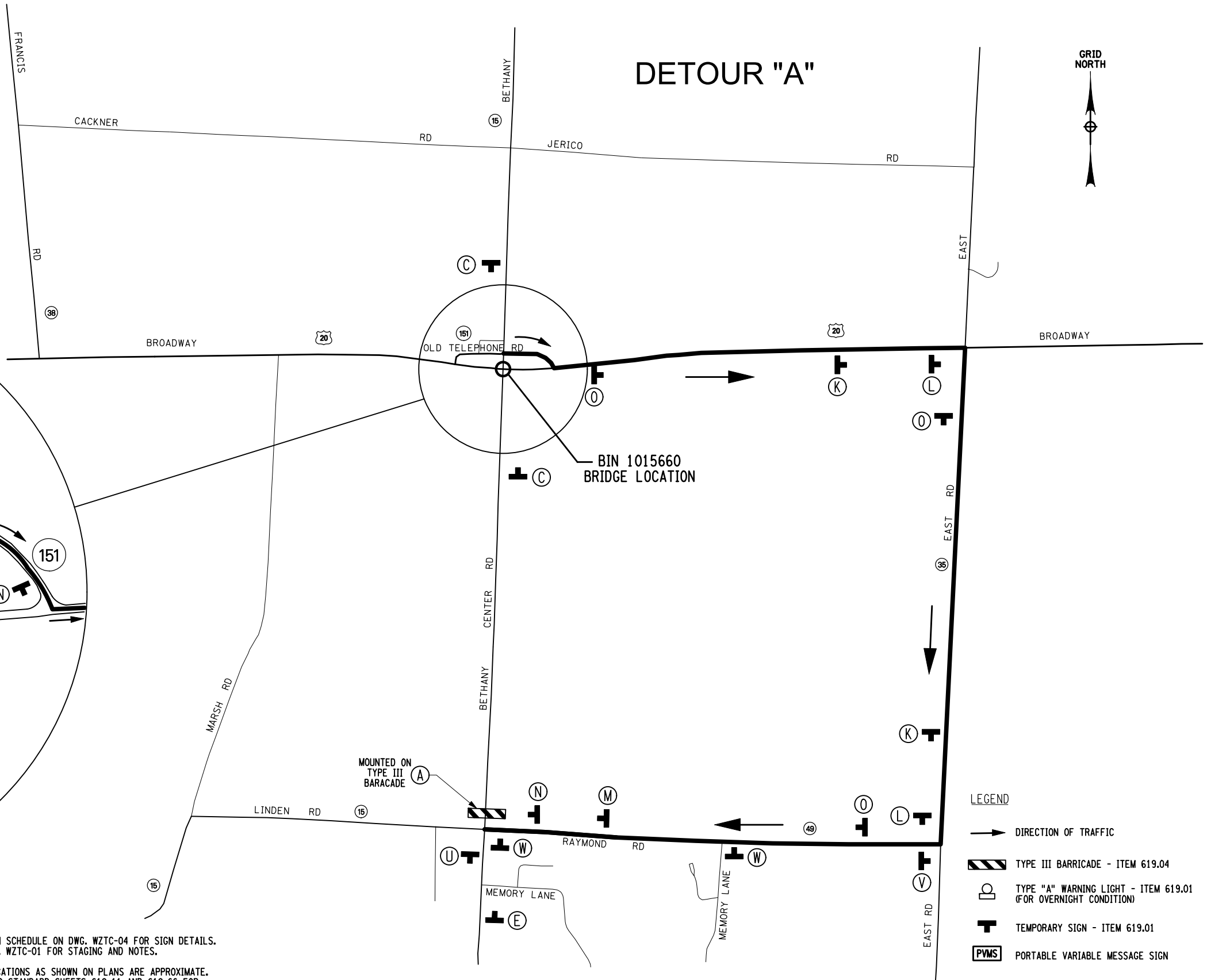
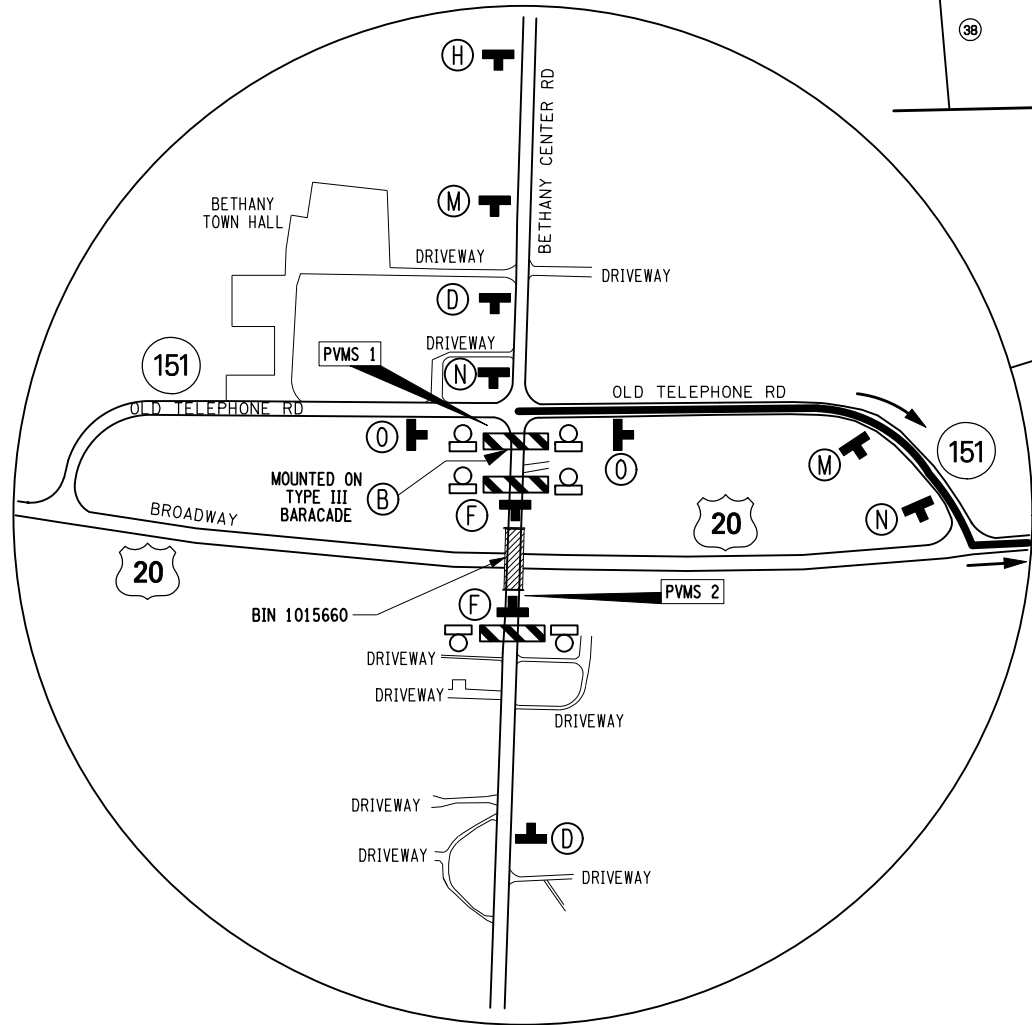

- LEGEND**
- DIRECTION OF TRAFFIC
 - ▨ TYPE III BARRICADE - ITEM 619.04
 - TYPE "A" WARNING LIGHT - ITEM 619.01 (FOR OVERNIGHT CONDITION)
 - ⊥ TEMPORARY SIGN - ITEM 619.01
 - PVMS PORTABLE VARIABLE MESSAGE SIGN

NOTES:

1. SEE SIGN SCHEDULE ON DWG. WZTC-04 FOR SIGN DETAILS. SEE DWG. WZTC-01 FOR STAGING AND NOTES.
2. SIGN LOCATIONS AS SHOWN ON PLANS ARE APPROXIMATE. REFER TO STANDARD SHEETS 619-11 AND 619-66 FOR SIGN LOCATION AND SPACING.

AS-BUILT REVISIONS DESCRIPTION OF ALTERATIONS:	BETHANY CENTER ROAD (CR 15) OVER ROUTE 20: BRIDGE REPLACEMENT S.H. 8431, ALEXANDER - CANAWAUGUS, PART 2 COUNTY: GENESEE REGION: 04
---	---

PIN 4020.10 US 20	BRIDGES 1015660	CULVERTS	ALL DIMENSIONS IN FT UNLESS OTHERWISE NOTED WZTC & SOUTH BOUND DETOUR	CONTRACT NUMBER
				DRAWING NO. WZTC-02 SHEET NO. 09

IT IS A VIOLATION OF LAW FOR ANY PERSON, UNLESS THEY ARE ACTING UNDER THE DIRECTION OF A LICENSED PROFESSIONAL ENGINEER, ARCHITECT, LANDSCAPE ARCHITECT, OR LAND SURVEYOR, TO ALTER AN ITEM IN ANY WAY. IF AN ITEM BEARING THE STAMP OF A LICENSED PROFESSIONAL IS ALTERED, THE ALTERING ENGINEER, ARCHITECT, LANDSCAPE ARCHITECT, OR LAND SURVEYOR SHALL STAMP THE DOCUMENT AND INCLUDE THE NOTATION "ALTERED BY" FOLLOWED BY THEIR SIGNATURE, THE DATE OF SUCH ALTERATION, AND A SPECIFIC DESCRIPTION OF THE ALTERATION.

AFFIX SEAL:
ON:

ALTERED BY:
ON:



FILE NAME = 402010_cph_wztc.02.dgn
DATE/TIME = 18-JUL-2017 13:18
USER = csgould

PROJECT MANAGER W. ALDEN
CHECK H. RESSEL
DRAFTING C. LANGDON
DESIGN H. RESSEL
JOB MANAGER H. RESSEL
DESIGN SUPERVISOR W. ALDEN



US ROUTE 20
SHORT TERM DETOUR

DETOUR "B"

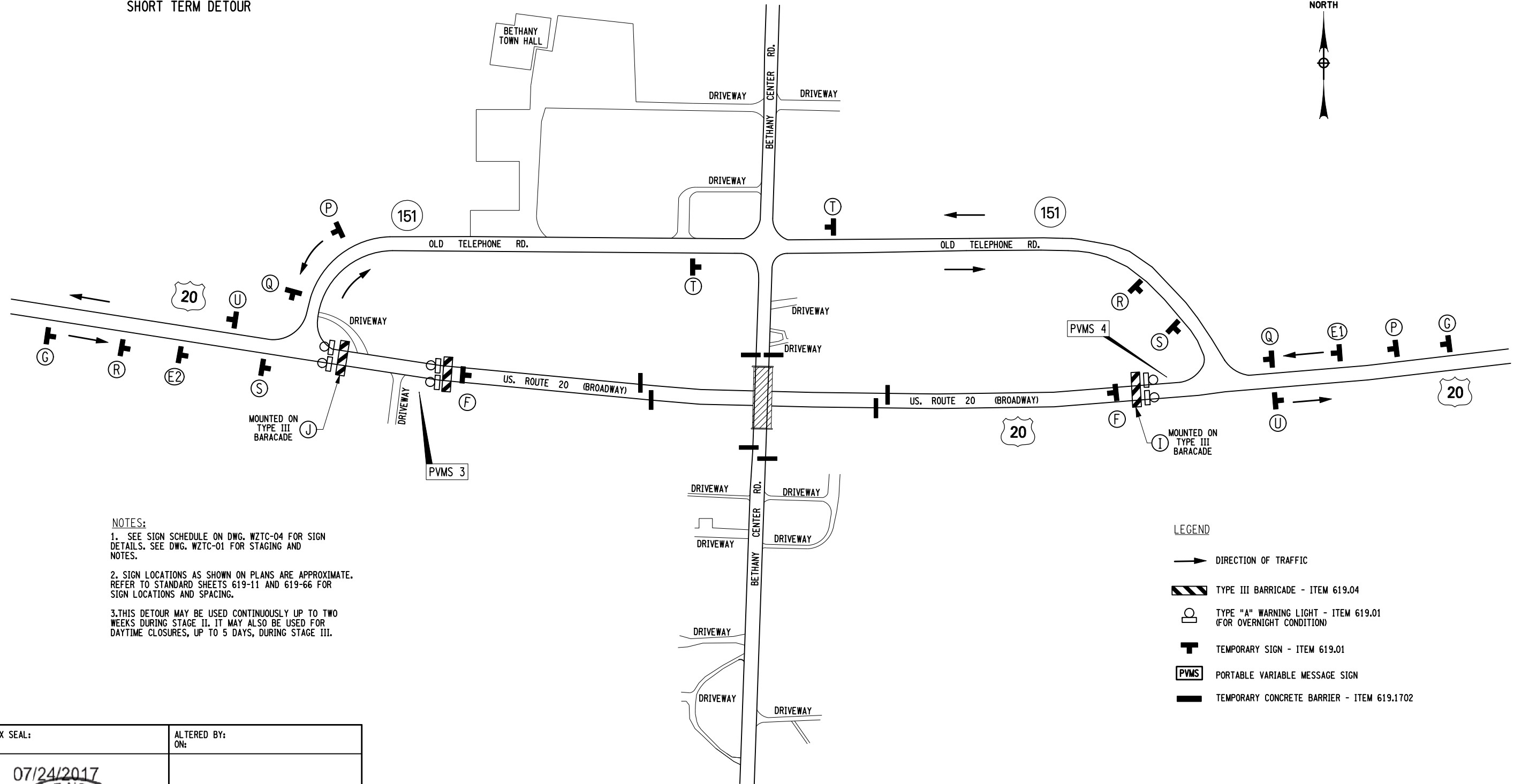

NOTES:

1. SEE SIGN SCHEDULE ON DWG. WZTC-04 FOR SIGN DETAILS. SEE DWG. WZTC-01 FOR STAGING AND NOTES.
2. SIGN LOCATIONS AS SHOWN ON PLANS ARE APPROXIMATE. REFER TO STANDARD SHEETS 619-11 AND 619-66 FOR SIGN LOCATIONS AND SPACING.
3. THIS DETOUR MAY BE USED CONTINUOUSLY UP TO TWO WEEKS DURING STAGE II. IT MAY ALSO BE USED FOR DAYTIME CLOSURES, UP TO 5 DAYS, DURING STAGE III.

LEGEND

- DIRECTION OF TRAFFIC
- ▨ TYPE III BARRICADE - ITEM 619.04
- TYPE "A" WARNING LIGHT - ITEM 619.01 (FOR OVERNIGHT CONDITION)
- T TEMPORARY SIGN - ITEM 619.01
- PVMS PORTABLE VARIABLE MESSAGE SIGN
- █ TEMPORARY CONCRETE BARRIER - ITEM 619.1702

AFFIX SEAL:
ON:

ALTERED BY:
ON:



AS-BUILT REVISIONS
DESCRIPTION OF ALTERATIONS:

BETHANY CENTER ROAD (CR 15) OVER ROUTE 20:
BRIDGE REPLACEMENT
S.H. 8431, ALEXANDER - CANAWAUGUS, PART 2
COUNTY: GENESEE REGION: 04

PIN 4020.10
US 20

BRIDGES
1015660

CULVERTS

ALL DIMENSIONS IN FT UNLESS OTHERWISE NOTED
WZTC & US. ROUTE 20 DETOUR

CONTRACT NUMBER

DRAWING NO. WZTC-03
SHEET NO. 10

IT IS A VIOLATION OF LAW FOR ANY PERSON, UNLESS THEY ARE ACTING UNDER THE DIRECTION OF A LICENSED PROFESSIONAL ENGINEER, ARCHITECT, LANDSCAPE ARCHITECT, OR LAND SURVEYOR, TO ALTER AN ITEM IN ANY WAY. IF AN ITEM BEARING THE STAMP OF A LICENSED PROFESSIONAL IS ALTERED, THE ALTERING ENGINEER, ARCHITECT, LANDSCAPE ARCHITECT, OR LAND SURVEYOR SHALL STAMP THE DOCUMENT AND INCLUDE THE NOTATION "ALTERED BY" FOLLOWED BY THEIR SIGNATURE, THE DATE OF SUCH ALTERATION, AND A SPECIFIC DESCRIPTION OF THE ALTERATION.



FILE NAME = 402010_cph_wztc_03.dgn
DATE/TIME = 18-JUL-2017 13:18
USER = cpguld

PROJECT MANAGER W. ALDEN
CHECK H. RESSEL
DRAFTING C. LANGDON
CHECK H. RESSEL
DESIGN H. RESSEL
JOB MANAGER H. RESSEL
DESIGN SUPERVISOR W. ALDEN